

ITEM NO.:

Description: Corridor Sconce

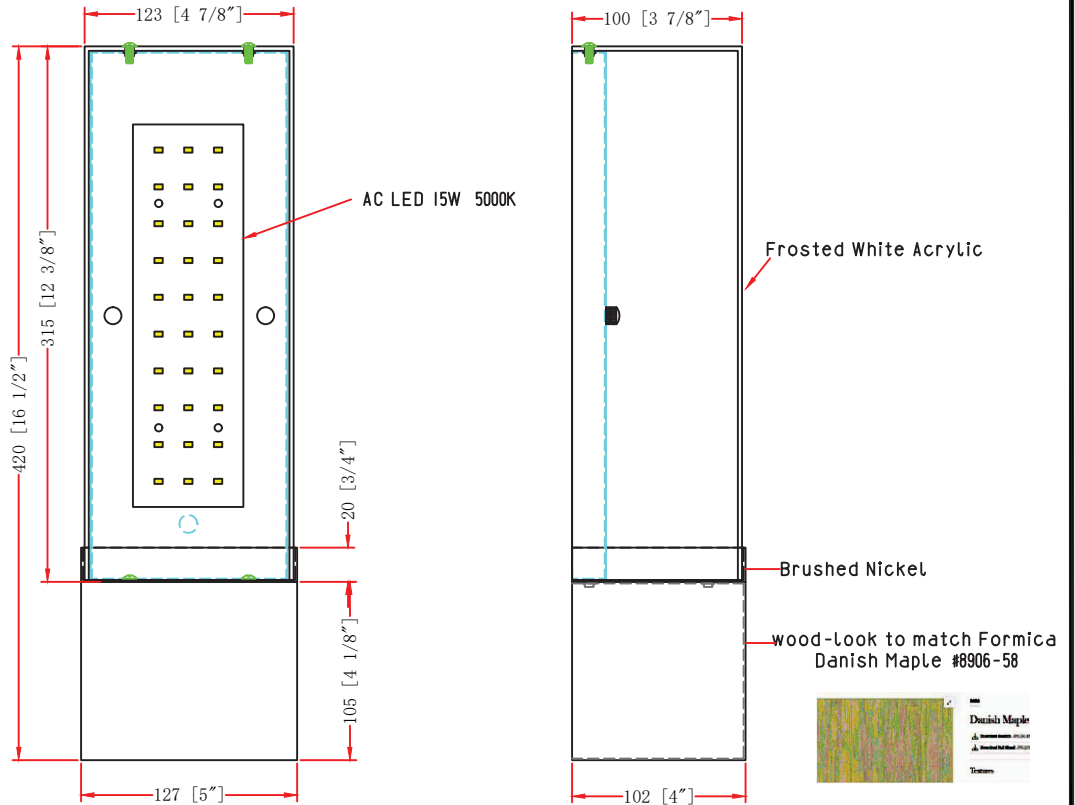

LINE DRAWING



STANDARD FEATURES:

- Corridor Sconce
- UL APPROVED FOR DRY LOCATION
- MATERIAL : STEEL+Acrylic
- USE 120V 60HZ AC
- LAMP/WATT: AC LED 15W 5000K

FIXTURE DATA

MODEL NO.	FINISH	SHADE	SIZE			TYPE OF LAMPS
			WIDTH	HEIGHT	EXTENTION	
US-SC400	Brushed Nickel+wood -look to match Formica Danish Maple #8906-58	Frosted White Acrylic	4.875"	16.5"	4"	AC LED 15W 5000K

LIGHT BULB DATA

BULB TYPE	BASE TYPE(SOCKET)	WATTAGE RATED	RATED LIFE (Hours)	Approx. LIGHT (Lumens)	Approx. Color (Temp. K)	Luminous efficacy (LM/W)	CRI
LED		15W			5000k		90

