

ITEM NO.:

Description: Corridor Sconce

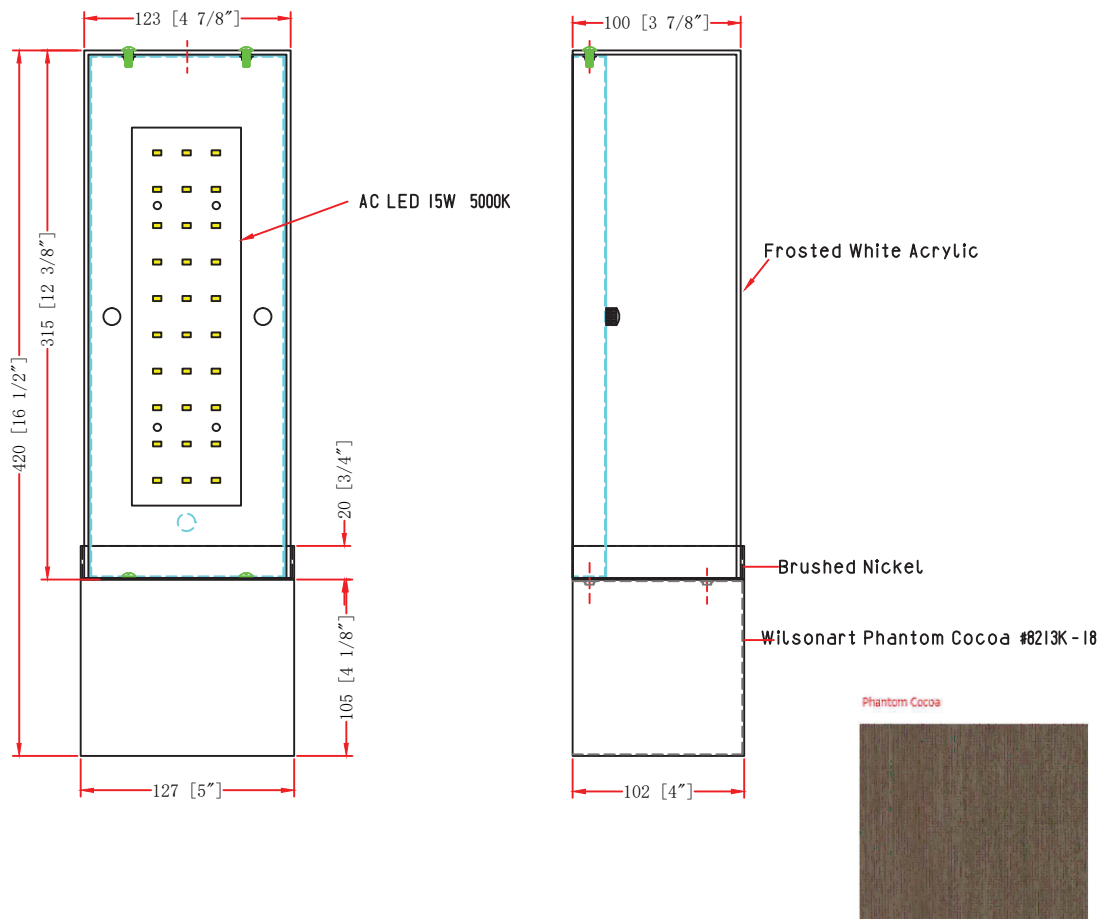

LINE DRAWING



STANDARD FEATURES:

- Corridor Sconce
- UL APPROVED FOR DRY LOCATION
- MATERIAL : STEEL+Acrylic
- USE 120V 60HZ AC
- LAMP/WATT: AC LED 15W 5000K

FIXTURE DATA

MODEL NO.	FINISH	SHADE	SIZE			TYPE OF LAMPS
			WIDTH	HEIGHT	EXTENTION	
US-SC400-COcoa	Brushed Nickel	Brushed Nickel+ Wilsonart Phantom Cocoa #8213K-18	4.875"	16.5"	4"	AC LED 15W 5000K

LIGHT BULB DATA

BULB TYPE	BASE TYPE(SOCKET)	WATTAGE RATED	RATED LIFE (Hours)	Approx. LIGHT (Lumens)	Approx. Color (Temp. K)	Luminous efficacy (LM/W)	CRI
LED		15W			5000k		90

