

ITEM NO.:

Description: Corridor Sconce

LINE DRAWING



LED Lighting for Hospitality & C-Stores

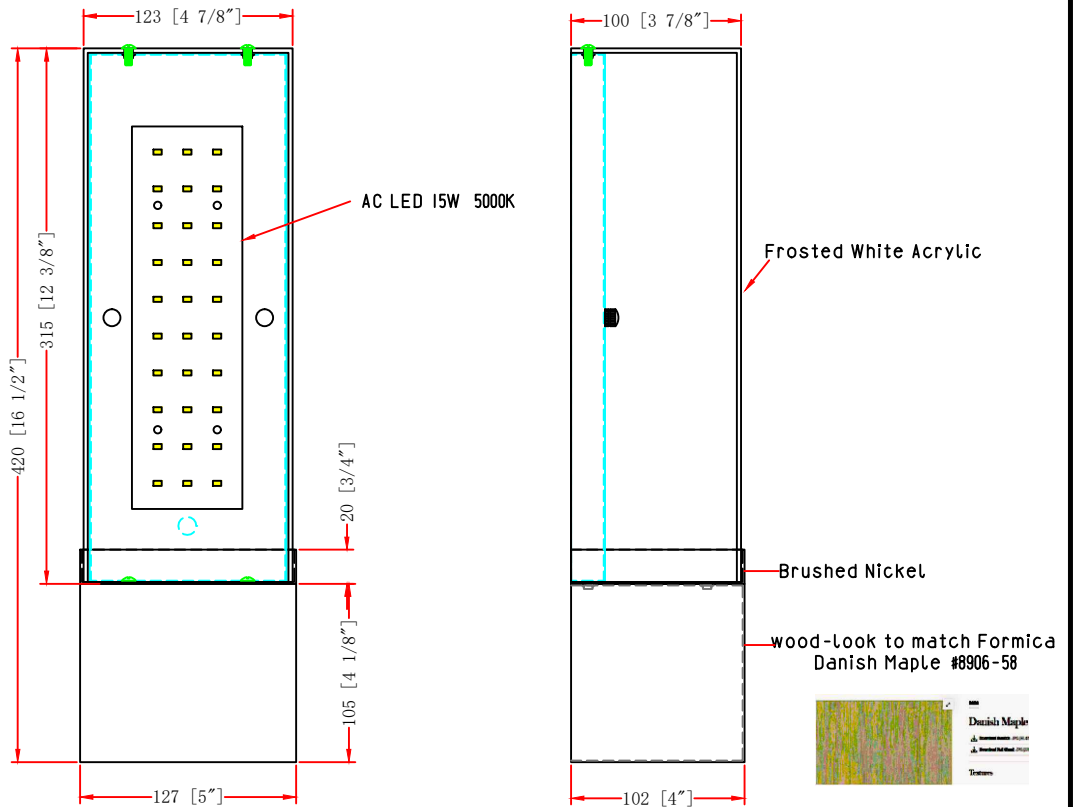

STANDARD FEATURES:

- Corridor Sconce
- UL APPROVED FOR DRY LOCATION
- MATERIAL: STEEL+Acrylic
- USE 120V 60HZ AC
- LAMP/WATT: AC LED 15W 5000K

FIXTURE DATA

| MODEL NO. | FINISH | SHADE | SIZE | | | TYPE OF LAMPS |
|-----------|--|--------------------------|--------|--------|-----------|------------------|
| | | | WIDTH | HEIGHT | EXTENTION | |
| US-SC400 | Brushed Nickel+wood -look to match Formica Danish Maple #8906-58 | Frosted White Acrylic | 4.875" | 16.5" | 4" | AC LED 15W 5000K |

LIGHT BULB DATA

| BULB TYPE | BASE TYPE(SOCKET) | WATTAGE RATED | RATED LIFE (Hours) | Approx. LIGHT (Lumens) | Approx. Color (Temp. K) | Luminous efficacy (LM/W) | CRI |
|-----------|-------------------|---------------|--------------------|------------------------|-------------------------|--------------------------|-----|
| LED | | 15W | | | 5000k | | 90 |

